

LED LINEAR DOWNLIGHT

MODEL: EPI-DL2W

Precise and homogeneous illumination, high flexibility to any architectural lighting concept .

OVERVIEW

- * Innovative modern design, high-end flexible decorative lamps.
- * UGR<13, advanced anti-glare reflectors with beam angle 15 /30 /45 degree optional, available for variety applications.
- * Deep recessed, great light and high visual comfort, excellent lighting effect.
- * LM80 approved Osram LEDs with lifetime more than 50,000 hours.
- * Innovative die-casting aluminum radiator design, better heat dissipation performance.
- * Designed to meet recommend luminance requirements for precise lighting in commercial lighting like shopping mall, showcase etc.

PHYSICAL DATA	
Dimension	L45*W45*H50 mm
Hole Size	37*37 mm
Lamp N.W.	107 g
PCB Thermal Conductivity	1.0WMK
Material	Aluminum Profile + Reflector + Lens
Color	Black /White /Customized

ELECTRICAL DATA	
Wattage	2W
Power Factor	PF>0.5
Voltage	110VAC
Driver	Flicker-free
Output Efficiency	>90%
Surge Protection	>2.5KV

OPTICAL DATA	
Lumen Flux	>110LM
Lamp Efficacy	>55Lm/W
LEDs	Osram (LM80)
CRI	>80 / >90
CCT	3000K /4000K /5000K /6500K
UGR	<13
Beam Angle	15 /30 /45 Degree

LIFE DATA & OPERATING DATA	
Lifetime of Lamp	>50,000 hours (L70)
Lumen Maintenance	Calculated L70 @25°C ambient in Hours>72000 H
Warranty	3 Years
Working Temperature	-15°C+50°C
Recommend Install Height	<3M

APPLICATION

Lighting area like the Residential lighting-home decoration, dinning room, hallway; Commercial lighting-shopping mall, Jewelry shop, hotel, club; Exhibition center lighting-museum, concert hall, art gallery etc.



INSTALLATION

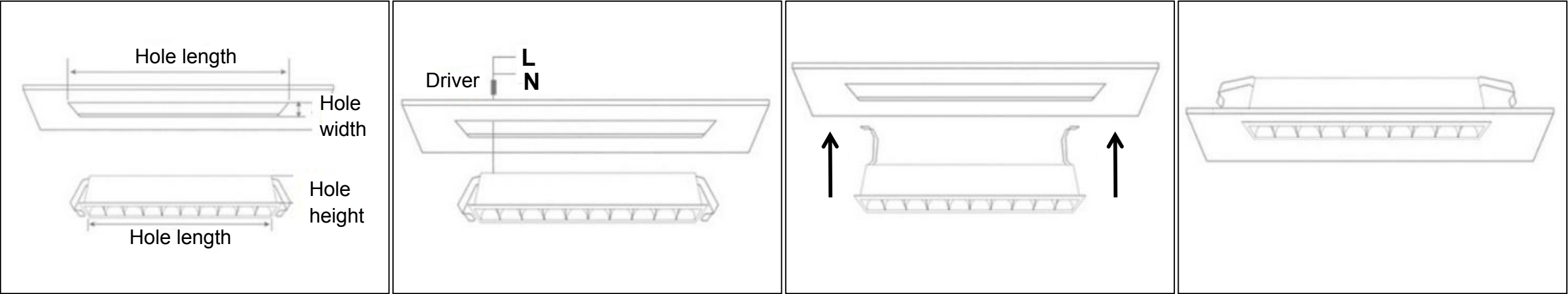

- 1. Make sure the position, cut out the suitable hole size.
- 2. Connect the driver with the wire.
- 3. Push the buckle, put the lamp into the hole, upward install.
- 4. Finish the installation.

PACKING

Watts	Lamp Size	QTY/CTN	Box Size	CTN Size	N.W./CTN	G.W./CTN	CBM
2W	45*45*50 MM	100 PCS	65*60*70 MM	35*32*30 CM	10.70 KG	12.30 KG	0.034